

# Wireless

ISB Connect, ISB, How, Where, What.

- [Wireless – ISB Connect, ISB, How, What, Where](#)
- [Connect to ISB \(we are deprecating the Mac network\)](#)
- [Connect to ISBConnect](#)

# Wireless – ISB Connect, ISB, How, What, Where

This information can only be viewed by ISB employees. Please Log In (upper-right corner) using your account (without @isb.be) and your password and follow this [link to access the document](#).

# Connect to ISB (we are deprecating the Mac network)

We are going to remove the Mac wireless network in a couple of days.

If you are still connected to the Mac network, please follow these simple steps to change to ISB.

Open Self Service, find the Remove Mac Network icon, and press Remove. The script usually takes 10 to 15 seconds to finish, and once done, your Macbook should automatically connect to ISB. The 'Remove' button in Self Service will change to 'Remove again.'

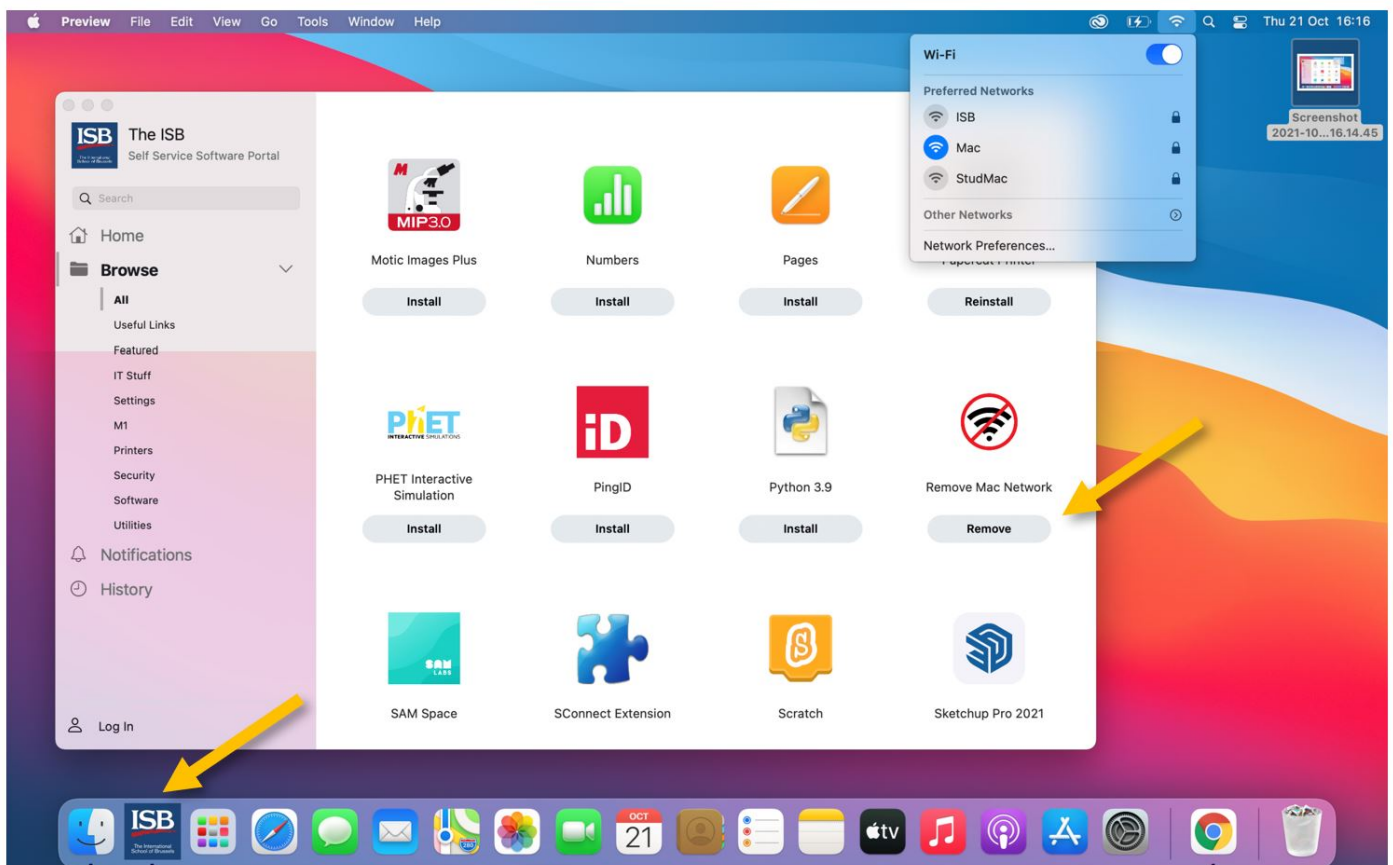

If for some reason your computer fails to connect to the ISB network please stop by the IT office.

# Connect to ISBConnect

**ISBConnect** is our guest WiFi network and can be accessed by anybody.

**Before connecting, please ensure that the MAC randomizer of your device is off for ISBConnect.**

**For iPhones and iPads**, click the info bubble next to ISBConnect, scroll down, and make sure that "Private Wi-Fi Address" is turned off.

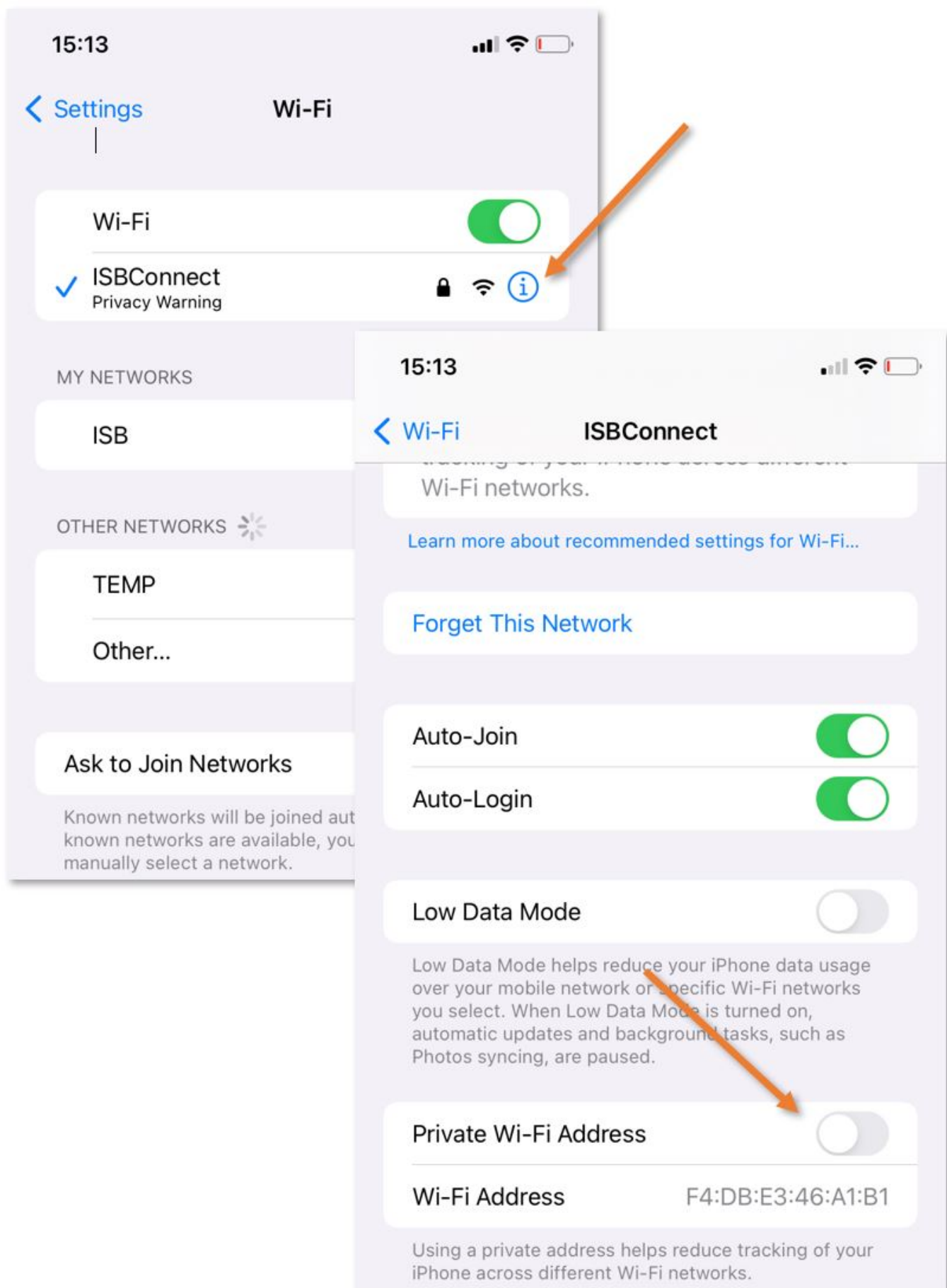

**For modern Android phones,** click on the cogwheel next to ISBConnect and change "Use randomized MAC" to "Use device MAC." (If the option is missing, you can continue connecting.)

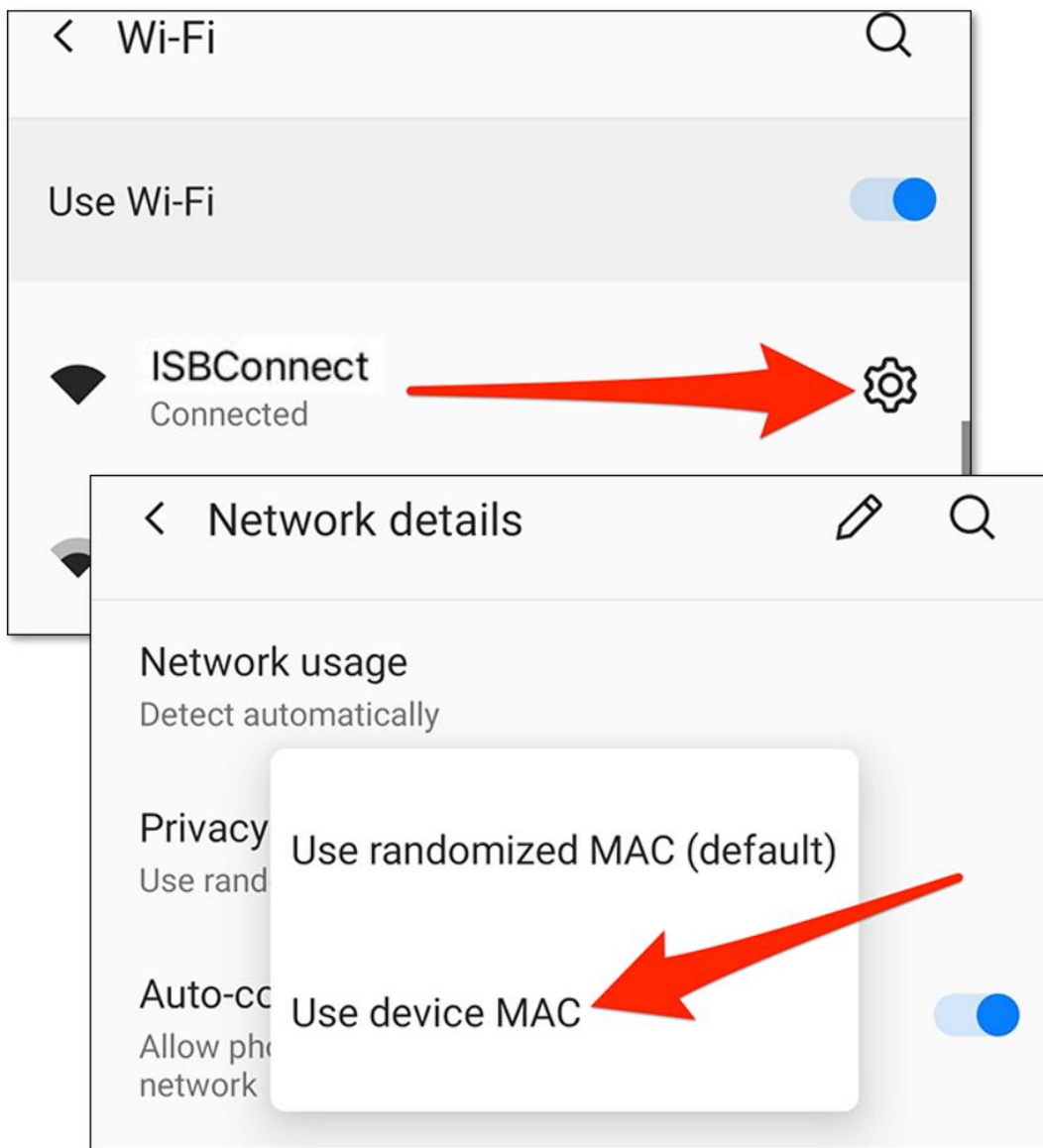

The password for ISBConnect is:  
**19kattenberg1170bxi**

After inserting the above password, the underneath window will pop up. Please fill in your First, Last Name and your Email (preferably one that you can access fast). Accept the terms of use and press Register. (more underneath)

10:59

4G

netconnect.isb.be

ISBConnect

<

>

Log In

Cancel

ISB Network

Already have an account? [Sign In](#)

Need an account? Please complete the form below to process the network access request.

Once your account is created with the Register button, please check your E-Mails and validate your account by using the link in the sent E-Mail (E-Mail with subject: **ISB Network account receipt**).

**You have 10 minutes to validate your account.**

First Name \*

Your first name.

Last Name \*

Your last name.

Email Address \*

Please enter your email address.  
This will become your username to log into the network.

\* Confirm:

☐ I accept the [terms of use](#)

Register

\* required field

ISB

The International School of Brussels

© Copyright The International School of Brussels 2022

Once you press Register, you will have internet for 10 minutes. Please check your email for a message similar to the one underneath. Click Confirm to extend the duration to 90 days.

If it doesn't work, connect to ISBConnect again and click on Sign In instead of filling in your First and Last Name. Use the username and password that you received in your email to finish connecting. You should be ready to go now.



Welcome Nicolae Marin,  
your account is ready to be used but requires a validation.

### Account validation:

To activate your account for 90 days, please click on the button  **Confirm** or [click here](#) to confirm its creation. *This operation must be done while connected to the ISB Network.*  
If the welcome page of the ISB Network display again, please connect using the below information.

### Connection information for a second device:

- 1 Connect to the wireless network : **ISBConnect** with the key **19kattenberg1170bxi**
- 2 Your device should automatically open the captive portal page or inform you to sign-in. If this is not the case, open manually the webpage [www.isb.be](http://www.isb.be)
- 3 Click on the link **Sign-in**.
- 4 Fill-in your credentials:
  - Username: **n1colae** @yahoo.com
  - Password: **583509**
- 5 Tick the checkbox to accept the Terms of Use after having read it

### Remember:

This account allows you to gain access to Internet as a guest. It is only created for this purpose and cannot be transfered or sold.

The credentials provided to the user are private and cannot be published.

The credentials are valid for the specified time.

In case of loss, the user must inform an internal responsible immediately.

Please refer to the Terms of Use of the network for the complete usage policy.